

# B4TYW02

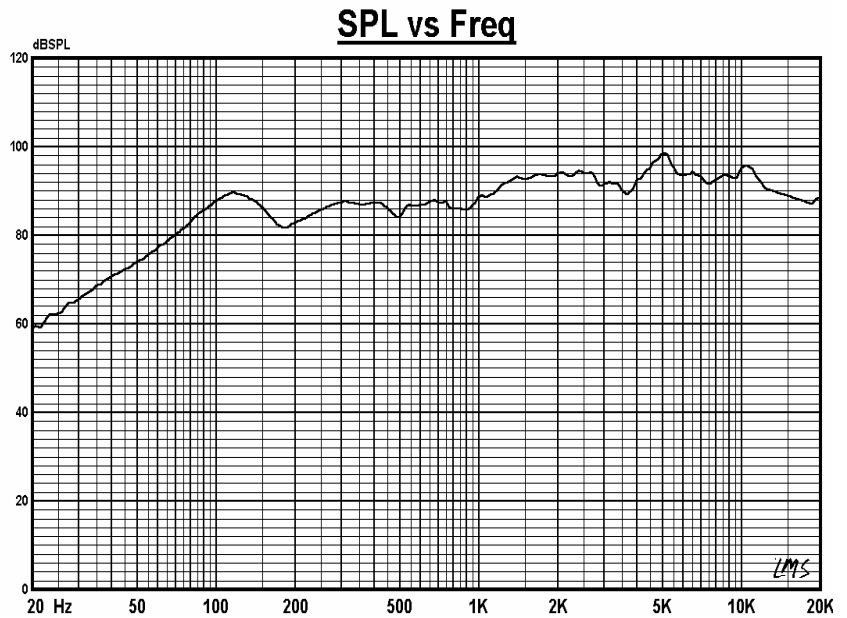
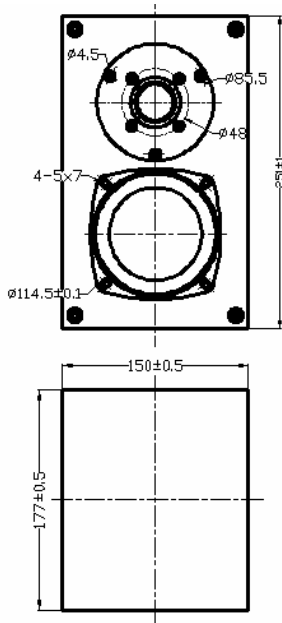

## Specifications & Thiele/Small Parameters

Impedance	: 8 Ohm
Minimum Frequency Response	: 55Hz
Reproduction Frequency Response	: Fo~20K
S.P.L.	: 88 dB/W(m)
Rated Input	: 50 W
Music Power	: 70 W

OEM& ODM WELCOME  
GUI-SOUND ELECTRONICS INDUSTRIAL CO.,LTD  
<http://www.gui-sound.com> E-mail: [sales@gui-sound.com](mailto:sales@gui-sound.com)